



DeliverHealth

eSOne Mobile for Android v3.8

Release Notes

What's New?

DeliverHealth is pleased to announce the release of eScription One Mobile for Android version 3.8. We have introduced support for additional appointment fields and dictation playback controls from the notification panel. Minor bug fixes are also included.

Additional Appointment Fields

Additional appointment fields available in Patient Displays are now supported in the Transcriptions tab of the eSOne Android mobile app. Based on Patient Display settings, these fields can be editable, read-only, and/or required. New fields include:

- Admit and Discharge Dates
- Patient Class
- Patient Type
- Account Number
- Admitting, Attending, Consulting, Primary Care, and Referring Physicians
- Floor
- Bed

Please note that the field labels and availability may differ depending on client setup.

Dictation Playback Controls

In addition to playback controls in the recording screen of the eSOne Android mobile app, playback can now be controlled from the Notification panel when a started or uploaded dictation is opened in the app. Swipe down from the top of the screen to open the Notification panel and control playback as needed.

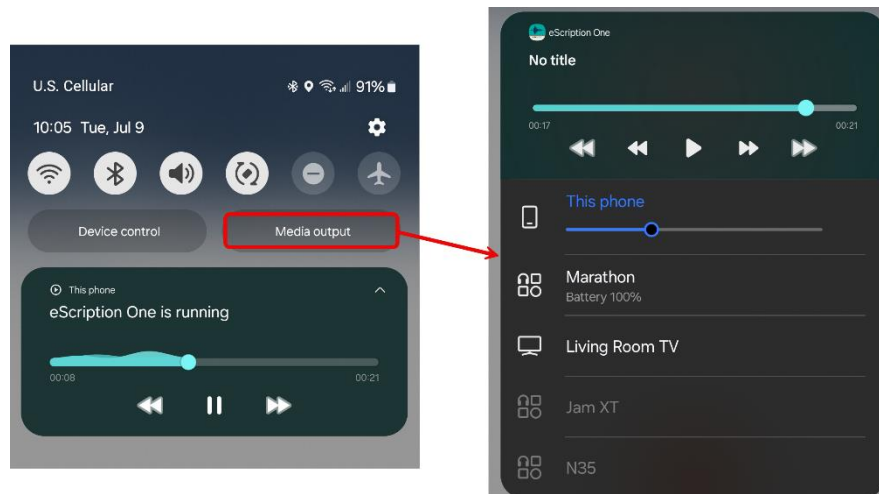

Open the Media output panel from the Notification panel to change the audio playback device. The recording device can still be selected within the eSOne Android mobile app.

Additional Changes

- Transcriptions tab - Required Appointment and Demographic fields and are now denoted with a red asterisk in the Information sub-tab.
- Patients tab – The inpatient encounter search was corrected to use the Account Number label instead of the Order Number label.
- Patients tab - Resolved crashing issue when scrolling in the History sub-tab.

Minimum Application Requirements

- eScription One Mobile for Android requires an Android operating system that still receives security updates from Android; Android OS9 or higher.
- Internet Access through a wireless Local Area Network (LAN) connection or through a phone service provider. It is strongly recommended to use a Wi-Fi LAN connection when uploading dictations. Minimum bandwidth: LTE/4G data connection; stable Wi-Fi with 3 Mbps download/1 Mbps upload or greater is recommended.
- A microphone for dictating is needed.
- Communicates over port 443 to <https://mobile.escription-one.com> using TLS 1.2.